

ATA AIRLINES, INC.

RECIRCULATION AIR CHECK VALVES

PAGE 1 / 1

CHECK BEING PERFORMED: Custom

ZONES: 121 126
A/C NUMBER:
REV. DATE: 04/21/99
FREQUENCY: 4C

W/C NUMBER: 211I2102 DATE:
W/O:
JAC CODE:

PANELS

1211 821
1251

REFERENCES

1
MECH INSP

VISUALLY CHECK CONDITION OF RECIRCULATION AIR CHECK VALVES
FLAPPER AND HINGE PIN FOR WEAR AND SECURITY (REMOVAL FROM
DUCT REQUIRED)

A References

1 21-25-03/401, Recirculation Air Check Valve

B Examine the Recirculation Air Check Valve

XXXXX 1 Remove the applicable (left and right) check valve
(Ref 21-25-03).

XXXXX 2 Look for these conditions on the check valve:
a A part of the check valve is not installed.
b The housing is cracked or corroded.
c The flappers do not move freely.
d The area of the flapper that contacts the stop pin is
less than .03 inches in thickness.
e The surfaces between the flapper and the housing has
carbon deposits or is not equally worn.
f The hinge pin can come out of the flappers or the
housing.

XXXXX 3 If any of these conditions are found, then install a new
check valve (Ref 21-25-03).

XXXXX 4 If none of these conditions are found, then install the
same check valve (Ref 21-25-03).

RECIRCULATION AIR CHECK VALVES

PAGE:2 /1

A/C NUMBER:

CHECK BEING PERFORMED: Cust

W/C NUMBER: 211I2102 (continued)

MECH: INSP:

---

\*\*\*\*\*END OF WORKCARD\*\*\*\*\*

---

REVISION DATE: 04/21/99

ATA AIRLINES, INC. B757 FLEET

W/C #: 211I2102

DATE WORK CARD COMPLETE \_\_\_/\_\_\_/\_\_\_

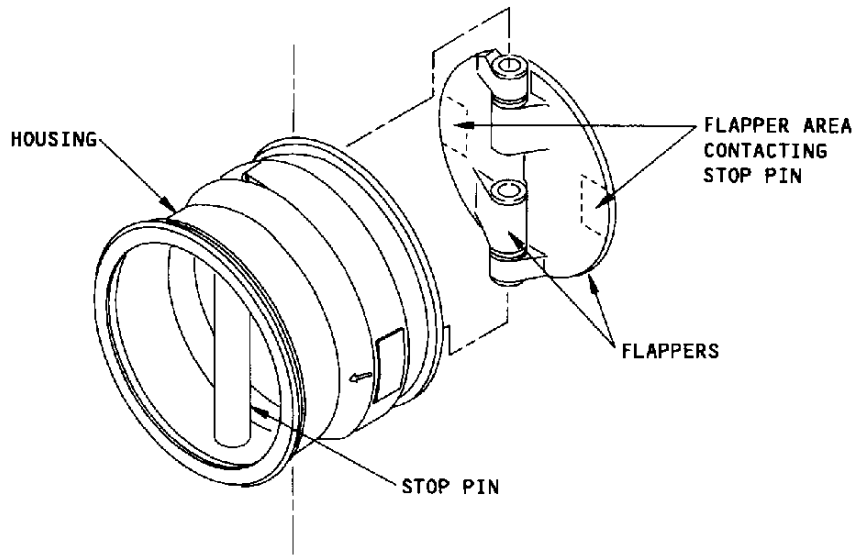
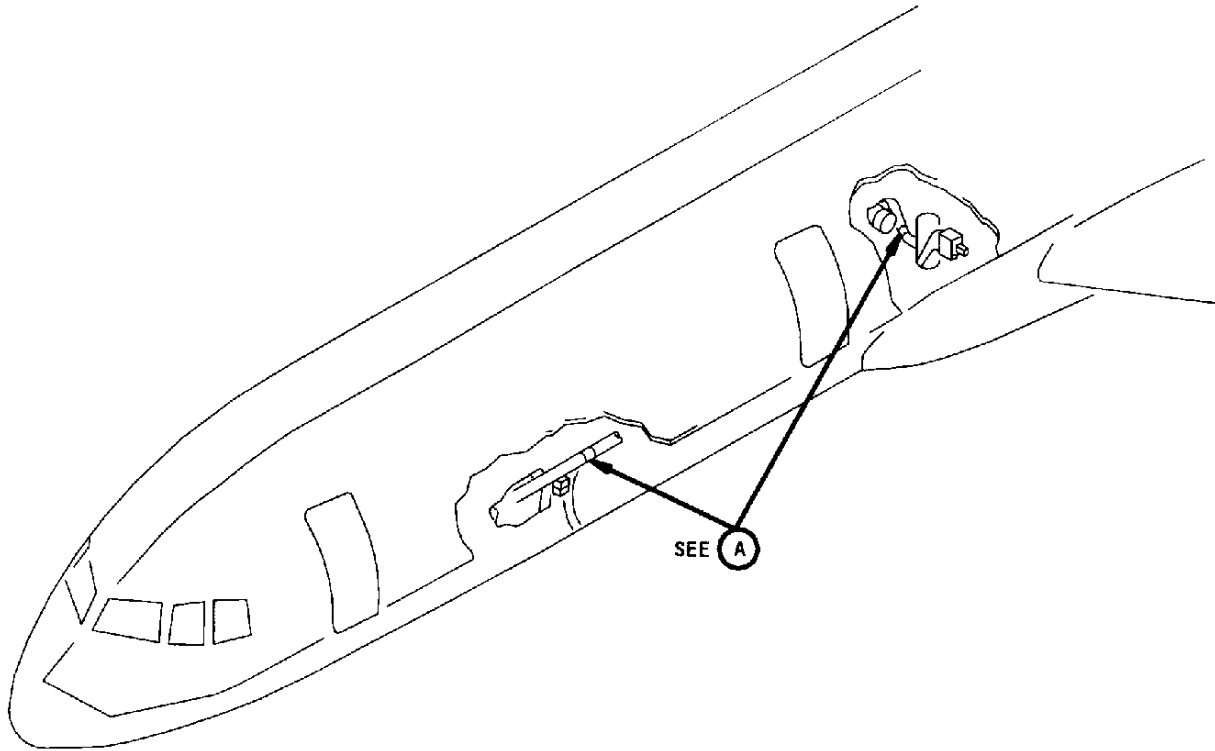

RECIRCULATION AIR CHECK VALVE

(A)