

ATA AIRLINES, INC.

CABIN AIR SUPPLY CHECK VALVES - VISUAL CHECK

PAGE 1 / 3

CHECK BEING PERFORMED: Custom

ZONES: 135 136
A/C NUMBER:
REV. DATE: 05/06/02
FREQUENCY: 4C

W/C NUMBER: 215I2103 DATE:
W/O:
JAC CODE:

MFR P/N DESCRIPTION QTY
213N1106-1 Gasket 2

PANELS

193HL
194ER

REFERENCES

Figure 1, AMM 21-51-15/401

MECH INSP

MPD TASK 21-001-01

VISUALLY CHECK CABIN AIR SUPPLY CHECK VALVE FLAPPER AND
HINGE PIN FOR CONDITION (REMOVAL FROM DUCT REQUIRED).

1 Examine the Cabin Air Supply Valves (Fig. 1)

A References

1 21-51-15/401, Cabin Air Supply Check Valve

B Prepare for the Check

XXXXX 1 Remove the left pack cabin air supply check valve
(Ref 21-51-15/401).

NOTE: Access through ECS access door 193HL

XXXXX 2 Remove the right pack cabin air supply check valve
(Ref 21-51-15/401).

NOTE: Access is through ECS access door 194ER

XXXX 1 C Do the Check (Left pack cabin air supply check valve)

1 Do a check of the check valve for the conditions
that follow:

a Damaged or missing parts.

b Evidence of crack or corrosion.

A/C NUMBER:

CHECK BEING PERFORMED: Cust

W/C NUMBER: 215I2103 (continued)

MECH: INSP:

- c Ensure the edges of the flapper valve are equally worn and do not have carbon particles (this indicates a leak when the valve is closed).
- d Ensure thickness of the flapper, where it contacts the stop, is more than 0.055 inches.
- e Ensure the flappers move easily.
- f If any of these conditions occur, mark the check valve as unservicable.

XXXX \_\_\_\_\_ D Do the Check (Right pack cabin air supply check valve)

1 Do a check of the check valve for the conditions that follow:

- a Damaged or missing parts.
- b Evidence of crack or corrosion.
- c Ensure the edges of the flapper valve are equally worn and do not have carbon particles (this indicates a leak when the valve is closed).
- d Ensure thickness of the flapper, where it contacts the stop, is more than 0.055 inches.
- e Ensure the flappers move easily.
- f If any of these conditions occur, mark the check valve as unservicable.

E Reinstall cabin air supply check valves

\_\_\_\_\_ XXXXX 1 Install the left pack cabin air supply check valve (Ref 21-51-15/401).

NOTE: Access is through ECS access door 193HL

\_\_\_\_\_ XXXXX 2 Install the right pack cabin air supply check valve (Ref 21-51-15/401).

CABIN AIR SUPPLY CHECK VALVES - VISUAL CHECK

PAGE:3 /3

A/C NUMBER:

CHECK BEING PERFORMED: Cust

W/C NUMBER: 215I2103 (continued)

MECH: INSP:

---

NOTE: Access is through ECS access door 194ER

\*\*\*\*\* END OF WORKCARD \*\*\*\*\*

---

REVISION DATE: 05/06/02

ATA AIRLINES, INC. B757 FLEET

W/C #: 215I2103

DATE WORK CARD COMPLETE \_\_\_/\_\_\_/\_\_\_

215I2103

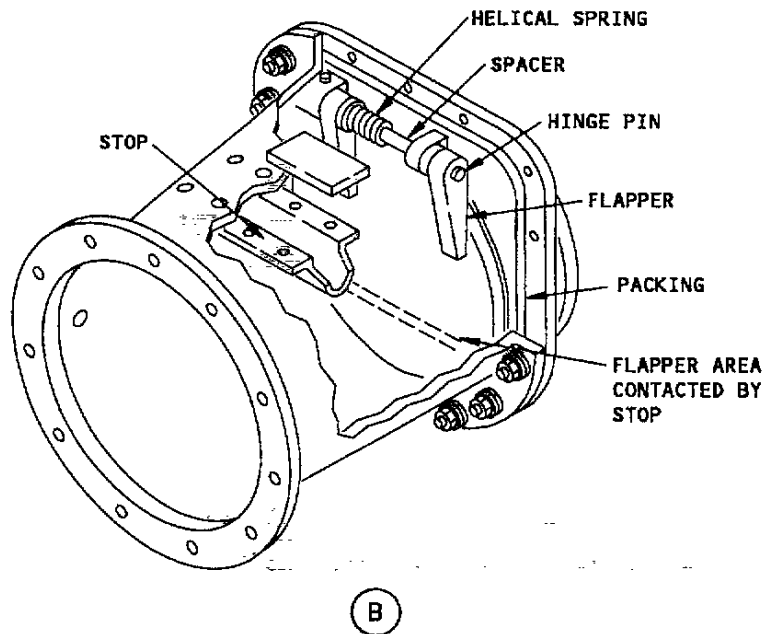
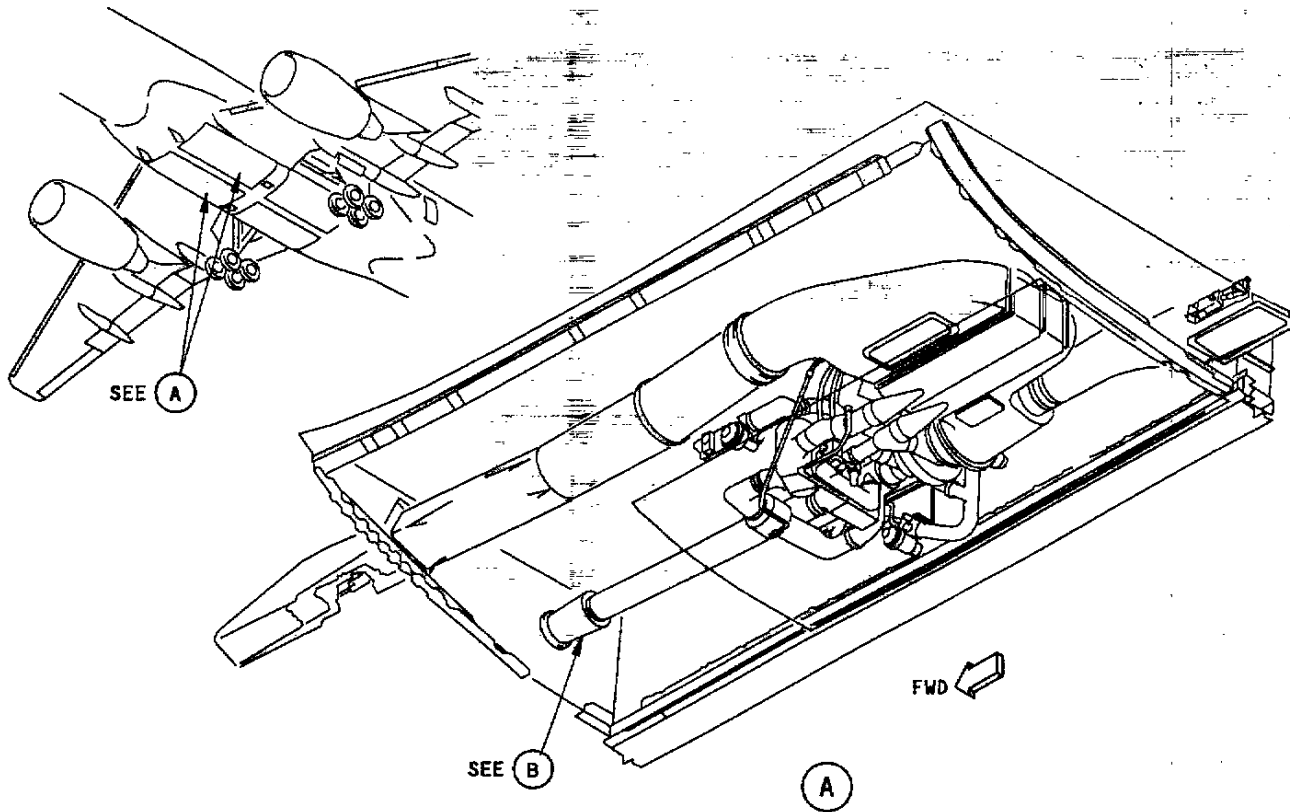

ZONE DUCT OVERHEAT SWITCH FIGURE 1

08/06/1998