

**ATA AIRLINES, INC.**

APU/GEN FILTER DIFFERENTIAL PRESSURE INDICATORS

PAGE 1 / 4

CHECK BEING PERFORMED: Custom

ZONES: 315  
A/C NUMBER:  
REV. DATE: 11/14/03  
FREQUENCY: 1A

W/C NUMBER: 231M4902      DATE:  
W/O:  
JAC CODE:

MFR P/N	DESCRIPTION	QTY
3001436-1	ELEMENT	A/R
S9413-227	PACKING	A/R
AN6227-19	PACKING	A/R

**PANELS**

315AL  
154AR

**REFERENCES**

1

**MECH      INSP**

MPD TASK 49-27-03-2C  
MPD TASK 49-27-03-2D

VISUALLY CHECK THE APU GENERATOR SCAVENGE FILTER DIFFERENTIAL PRESSURE INDICATOR FOR ACTIVATION.

VISUALLY CHECK THE APU OIL PRESSURE FILTER DIFFERENTIAL PRESSURE INDICATOR FOR ACTIVATION.

1. Filter Element Differential Pressure Indicator Inspection (Fig. 1).

A. References.

- (1) 49-27-07/401, Oil Filter Differential Pressure Indicator.
- (2) 49-27-16/401, Generator Oil Filter Differential Pressure Indicator.
- (3) IPC 49-27-01 Fig. 1.
- (4) SSM 49-27-01.
- (5) WDM 49-14-11.

B. Procedure.

\_\_\_\_\_ XXXXX (1) Make sure the APU control switch on the P5 panel is OFF and attach a DO-NOT-OPERATE tag.

REVISION DATE: 11/14/03

ATA AIRLINES, INC. B757 FLEET

W/C #: 231M4902

DATE WORK CARD COMPLETE \_\_\_/\_\_\_/\_\_\_

A/C NUMBER:

CHECK BEING PERFORMED: Cust

W/C NUMBER: 231M4902 (continued)

MECH: INSP:

\_\_\_\_\_ XXXXX (2) Open these circuit breakers and attach DO-NOT-CLOSE tags:

(a) P11 Overhead Panel.

1) 11B34 APU ALTN CONT or APU MN BAT CONT

(b) E6 Rack, Aft Equipment Center.

1) APU CONT.

\_\_\_\_\_ XXXXX (3) Open the APU access doors 315AL and 316AR:

(a) Open the latches on the APU access doors.

(b) Open the APU access doors.

(c) Engage the support rods for the APU access doors.

\_\_\_\_\_ XXXXX (4) Do the visual inspection of the differential pressure indicators:

(a) Look at the differential pressure indicator (3) on the generator filter assembly.

1) If the indicator (3) is pushed out, do an inspection of the filter element (4) for the generator scavenge filter (Ref AMM 49-27-03/201 par. 4).

NOTE: This is an indication that the differential pressure is more than the limit and the generator scavenge filter has blockage.

2) If the filter element has blockage, replace it. Do these tasks: Oil Pressure and Generator Scavenge Filter Elements Removal and Oil Pressure and Generator Scavenge Filter Elements Installation.

A/C NUMBER:

CHECK BEING PERFORMED: Cust

W/C NUMBER: 231M4902 (continued)

MECH: INSP:

- 3) If the filter element does not have blockage, push the differential pressure indicator (3) in to set it.
- 4) If this is a continuous problem with this indicator, replace the differential pressure indicator (3) (Ref 49-27-16/401).

(b) Look at the differential pressure indicator (11) on the oil filter assembly.

- 1) If the indicator (11) is pushed out, do an inspection of the pressure filter element (8) (Ref AMM 49-27-03/201 par. 4).
- 2) If the filter element has blockage, replace it. Do these tasks: Oil Pressure and Generator Scavenge Filter Elements Removal and Oil Pressure and Generator Scavenge Filter Elements Installation.
- 3) If the pressure filter element does not have blockage, push the differential pressure indicator (11) in to set it.
- 4) If this is a continuous problem with this indicator, replace the differential pressure indicator (11) (Ref 49-27-07/401).

\_\_\_\_\_ XXXXX (5) Put Aircraft Back to its Usual Condition.

(a) Close APU access panels unless required for other MX.

- 1) Disengage the support rods for the APU access doors.
- 2) Put the support rods in the clips on the inner side of the APU access doors.
- 3) Lift the right access door until the spring latch, at the forward end of the door,

A/C NUMBER:

CHECK BEING PERFORMED: Cust

W/C NUMBER: 231M4902 (continued)

MECH: INSP:

catches and holds the door on the fuselage frame.

4) Lift the left access door and align it with the right access door.

5) Close and latch the APU access doors.

(b) Remove the DO NOT CLOSE tags and close the previously opened circuit breakers.

1) P11 Overhead Panel.

a) 11B34 APU ALTN CONT or APU MN BAT CONT

2) E6 Rack, Aft Equipment Center.

b) APU CONT.

(c) Remove the DO NOT OPERATE tag from the APU control switch on the P5 panel.

\*\*\*\*\*END OF WORKCARD\*\*\*\*\*

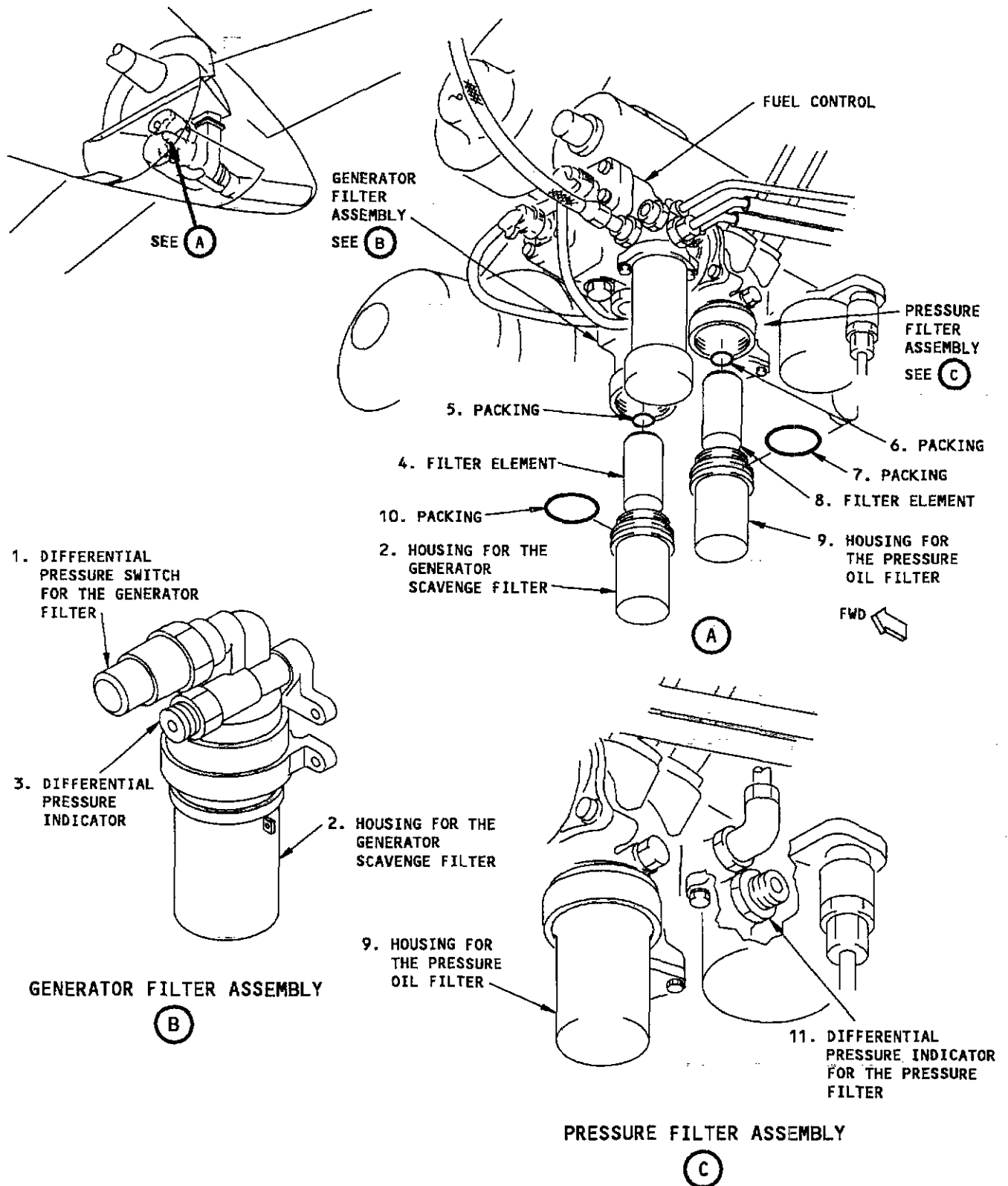

Oil Pressure and Scavenge Filter Elements Installation