

CHECK BEING PERFORMED: Custom

ZONES: 400
 A/C NUMBER:
 REV. DATE: 10/13/06
 FREQUENCY: 1C

W/C NUMBER: 241M7103
 DATE: 10/13/06
 W/O:
 JAC CODE:

MFR P/N	DESCRIPTION	QTY
OMat 1/24	De-carbonizer DeGreaser (BAT 95/OMat 1/24 Preferred)	A/R
OMat 139	Carbon Stripper	A/R
OMat 165	Carbon Stripper Inhibitor	A/R
Common	Non-Metallic Brush	A/R
T101446	SWAB, 3" COTTON SWAB	A/R

TOOLS	DESCRIPTION	QTY
Common	PROTECTIVE GLOVES	A/R
Common	COVERALLS	A/R
Common	FACE VISOR	A/R

REFERENCES

FIG 1; AMM 71-11-04-2; AMM 78-31-00-2; AMM 78-11-04-401; RR RB 211-535 CMM
 Tubes and Hoses 71-71-02

MECH INSP

| MPD ITEM: 71-999A

| RB211 TURBINE LOW POINT DRAIN TUBE CLEANING AND INSPECTION
 (#1 ENGINE)

1. Perform a Cleaning and Inspection of the RB211 Turbine
 Low Point Drain Tube.

A. Preparation

CAUTION: OBEY THE PRECAUTIONS FOR THE KEVLAR WRAPPING
 WHEN YOU OPEN THE FAN COWL PANEL.

_____ XXXXX (1) Open the fan cowl panels, reference AMM 71-11-04-2.

WARNING: DO THE THRUST REVERSER DEACTIVATION PROCEDURE TO
 PREVENT THE OPERATION OF THE THRUST REVERSER.

_____ XXXXX (2) Deactivate the thrust reverser for ground
 maintenance reference AMM 78-31-00-2.

WARNING: OBEY THE INSTRUCTIONS IN AMM 78-31-00-2 WHEN
 YOU OPEN THE THRUST REVERSERS.

_____ XXXXX (3) Open the thrust reverser per AMM 78-31-00-2.

| B. Remove fuel drain tube and perform the cleaning and
 inspection (REF FIG 1).

_____ XXXXX (1) Remove the UL11273 fuel drain tube per

A/C NUMBER:

CHECK BEING PERFORMED: Cust

W/C NUMBER: 241M7103 (continued)

MECH: INSP:

AMM 78-11-04-4.

- | _____ XXXXX (2) Perform the cleaning of the fuel drain tube.
- |
- | (a) Clean the UL11273 fuel drain tube.
- | (REF RR RB211 CMM Tubes and Hoses 71-71-02-100-000)
- |
- | 1) Prepare the degreaser solution.
- |
- | WARNING: YOU MUST USE GLOVES, OVERALLS, FACE VISOR,
- | AND SAFETY BOOTS WHEN YOU DO THIS
- | PROCEDURE. DO NOT BREATHE THE FUMES FROM
- | THE SOLUTION. THE FUMES CAN CAUSE DAMAGE
- | TO YOUR LUNGS.
- |
- | 2) Obtain the OMat 1/24 cleaner (Preferred cleaner
- | Bat 95/ OMat 1/24Q) or an equivalent OMat 1/24
- | substitute as called out in the RR RB211 CMM
- | Tubes and Hoses 71-71-02-100-000.
- |
- | 3) Mix the OMat 1/24 cleaner in a mild steel tank
- | or a suitable container in accordance with the
- | manufacture's instruction's.
- |
- | a) Heat BAT 95 solution to 120 - 140 degrees F.
- | If an alternate BAT 1/24 Aqueous Cleaning
- | solution is used, refer to RR OHM
- | 70-00-00-100-102 Process 102 for solution
- | temperature.
- |
- | 4) Clean the fuel drain tube in the cleaner.
- |
- | a) Make sure you remove all the carbon particles
- | that are loose before immersing part in tank.
- |
- | b) Fully immerse the part in the cleaning
- | solution and allow to soak for a sufficient
- | time for cleaning.
- |
- | NOTE: For a heavily carbon coated tube, it is
- | recommended to soak the fuel drain tube
- | for approximately 5 hours, to help
- | dissolve and loosen hard carbon
- | deposits. Additional soak time and or

A/C NUMBER:

CHECK BEING PERFORMED: Cust

W/C NUMBER: 241M7103 (continued)

MECH: INSP:

the use of an OMat 139 stripper and OMat 165 Inhibitor may be required. For stripper and Inhibitor use, refer to the appropriate RR RB 211 CMM Tubes and Hoses 71-71-02-100-000 for proper produres.

- c) Remove the fuel drain tube from the solution and let the unwanted solution drain back into the tank.

Note: Turn the drain tube so that all unwanted solution is removed from the blind holes in the tube.

- d) Clean the tube using a suitable swab or non-metallic bristle brush to assist with in cleaning.

- e) Flush the drain tube in a flow of clean, cold water. Use an air/water gun to flush the drain tube.

NOTE: If the carbon particles remain in the drain tube, repeat the cleaning process, using a bristle brush and compressed air to remove the particles.

- f) Do a final flush and draining of the tube utilizing cold water and compressed air.

XXXXX (3) Inspect the UL11273 fuel drain tube for cracks, dents, nicks, fretting, scoring and carbon build-up or residue as per AMM 71-71-02-6.

C. Install a serviceable UL11273 fuel drain tube (FIG 1).

XXXXX (1) OK to install fuel drain tube.

(2) Install a serviceable UL11273 fuel drain tube per AMM 78-11-04-4.

D. Close

#1 ENGINE TURBINE LOW POINT DRAIN TUBE

PAGE: 4 / 4

A/C NUMBER:

CHECK BEING PERFORMED: Cust

W/C NUMBER: 241M7103 (continued)

MECH: INSP:

WARNING: OBEY THE INSTRUCTIONS IN AMM 78-31-00-2 WHEN YOU
CLOSE THE THRUST REVERSERS.

_____ XXXXX (1) If no further engine maintenance is required, close
the thrust reverser and do the activation procedure
per AMM 78-31-00-2.

CAUTION: OBEY THE PRECAUTIONS FOR THE KEVLAR WRAPPING
WHEN YOU CLOSE THE FAN COWL PANEL.

_____ XXXXX (2) If no further engine maintenance is required, close
the fan cowls per AMM 71-11-04-2.

*****END OF WORKCARD*****

241M7103

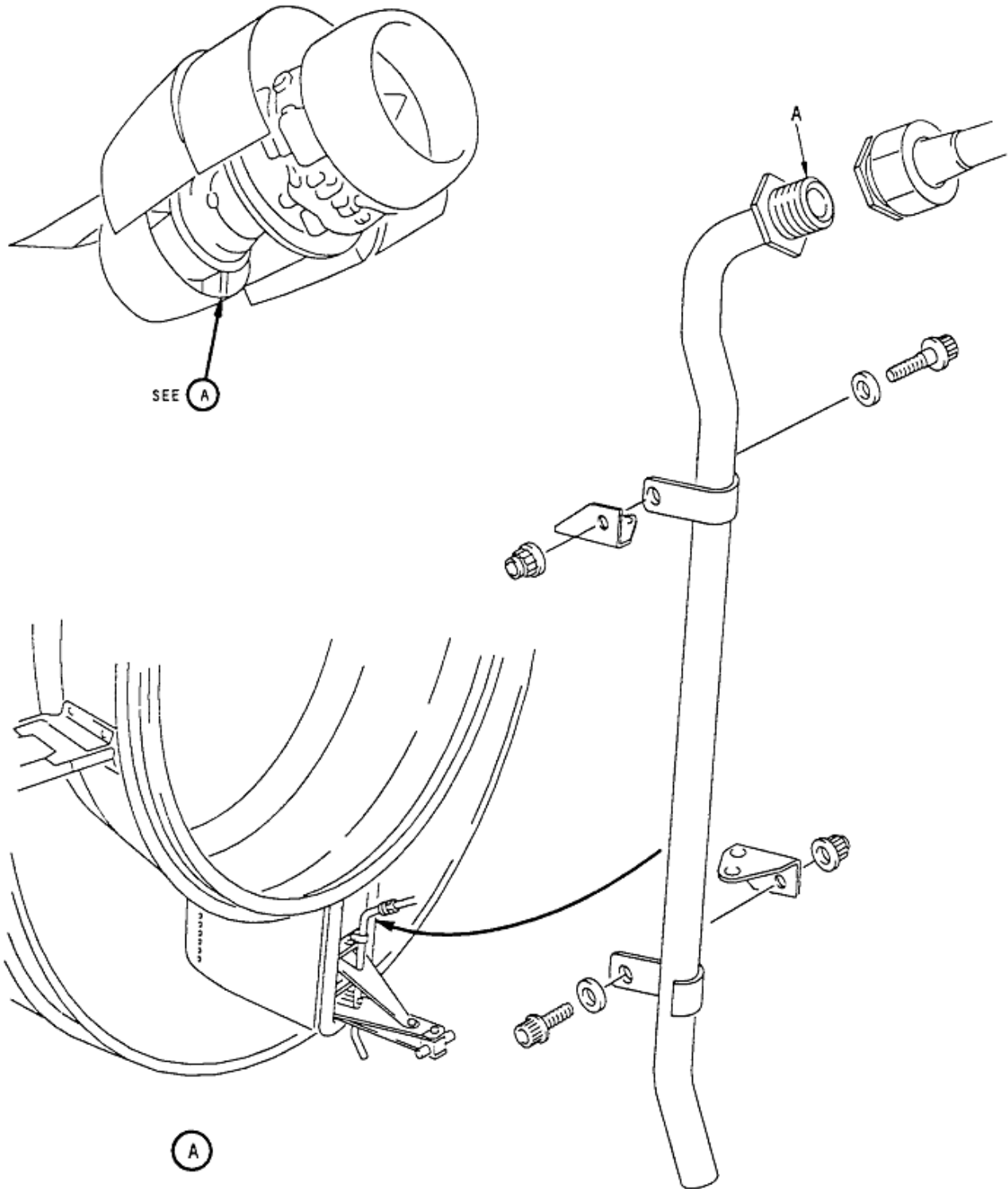

L.P. Turbine Case Fuel Drain Tube

DRAIN

FIGURE 1

08/06/1998