

ATA AIRLINES, INC.

#2 ENGINE OIL PRESSURE FILTER

PAGE 1 / 4

CHECK BEING PERFORMED: Custom

ZONES: 421
A/C NUMBER:
REV. DATE: 02/24/03
FREQUENCY: 2A

W/C NUMBER: 242R7901 DATE:
W/O:
JAC CODE:

MFR P/N	DESCRIPTION	QTY
AS43013-154	SEAL RING	1
11-10638	FILTER ELEMENT	1
	10 PINT CAPACITY CONTAINER	1
RRHU31261	DRAIN TOOL	1

PANELS

424AR

REFERENCES

Figure 1

MECH INSP

CLEAN THE RIGHT ENGINE OIL PRESSURE FILTER. (OFF AIRCRAFT).

THE FOLLOWING PROCEDURE APPLIES TO THE ON-AIRCRAFT PORTION OF THE TASK (REMOVAL/INSTALLATION):

1. Remove the Element of the Pressure Oil Filter.

A. Equipment.

(1) Clean Container - minimum capacity:

- (a) 10.0 U.S. pints.
- (b) 8.0 Imperial pints.
- (c) 5.0 Litres.

(2) Drain Tool, RRHU31261.

B. References.

(1) AMM 71-11-04/201, Fan Cowl Panels.

C. Prepare for the Removal.

CAUTION: OBEY THE PRECAUTIONS FOR THE KEVLAR WRAPPING WHEN YOU OPEN THE FAN COWL PANEL. IF THE PRECAUTIONS ARE NOT OBEYED, DAMAGE TO THE KEVLAR WRAPPING CAN OCCUR.

_____ XXXXX (1) Open the right fan cowl panel (AMM 71-11-04/201).

REVISION DATE: 02/24/03

ATA AIRLINES, INC. B757 FLEET

W/C #: 242R7901

DATE WORK CARD COMPLETE ___/___/___

#2 ENGINE OIL PRESSURE FILTER

A/C NUMBER:

CHECK BEING PERFORMED: Cust

W/C NUMBER: 242R7901 (continued)

MECH: INSP:

D. Remove the Element (Fig. 1).

WARNING: WHEN YOU USE THE SYNTHETIC ENGINE OIL, MAKE SURE YOU DO NOT TOUCH YOUR SKIN. IF YOU DO NOT OBEY THIS INSTRUCTION, INJURY TO PERSONS CAN OCCUR.

CAUTION: THE OIL IN THIS OIL SYSTEM CAN CAUSE DAMAGE TO THE PAINT AND SOME TYPES OF RUBBER. DO NOT PERMIT THE CONTAMINATION OF THOSE PARTS OF THE ENGINE. YOU MUST CLEAN THOSE PARTS THAT HAVE OIL ON THEM. IF YOU DO NOT OBEY THE INSTRUCTIONS, DAMAGE TO EQUIPMENT CAN OCCUR.

A SMALL QUANTITY OF ALKALINE CLEANING FLUIDS CAN CAUSE THE FAILURE OF THE SYNTHETIC OIL. USE FULLY CLEAN CONTAINERS AND EQUIPMENT FOR THE OIL. DO NOT PUT THE DRAINED OIL BACK INTO THE SYSTEM. IF YOU DO NOT OBEY THESE INSTRUCTIONS, DAMAGE TO EQUIPMENT CAN OCCUR.

_____ XXXXX

(1) Drain the filter housing (6) as follows:

- (a) Put the container below the filter housing (6).
- (b) Remove the drain cap (4) from the priming connector (3).
- (c) Install the drain tool in the priming connector (3).
- (d) Turn the drain tool to let the oil drain.
- (e) Disengage the drain tool.
- (f) Install the drain cap (4) on the priming connector (3).

1) Install the lockwire on the drain cap (4).

_____ XXXXX

(2) Remove the bolts (5) that attach the filter housing (6).

_____ XXXXX

(3) Remove the filter housing (6).

_____ XXXXX

(4) Remove the element (8) from the filter housing (6).

#2 ENGINE OIL PRESSURE FILTER

A/C NUMBER:

CHECK BEING PERFORMED: Cust

W/C NUMBER: 242R7901 (continued)

MECH: INSP:

2. Install the Element of the Pressure Oil Filter.

A. Parts.

		I.P.C.			
		NOMENCLATURE			
Figure	Item	Subject	Figure	Item	
1	1	Washer	79-21-04	01	22
	2	Washer			16
	3	Adapter Assy Connection - Oil Priming			55
	4	Cap			50
	5	Bolt			12
	6	Housing Assy-Pressure -Filter			6
	7	Ring			24
	8	Element-Pressure Filter			30J

B. References.

- (1) AMM 12-13-01/301, Engine-Servicing (Oil Replenishing).
- (2) AMM 71-00-00/501, Power Plant.
- (3) AMM 71-11-04/201, Fan Cowl Panels.
- (4) AMM 79-00-00/601, Oil.
- (5) AMM 79-21-04/701, Oil Filter Elements.

C. Install the Element (Fig. 1).

- _____ XXXXX (1) Lubricate the new seal ring (7) with oil.
- _____ XXXXX (2) Install the new seal ring (7) in the pressure filter housing (6) (AMM 70-02-01/201).
- _____ XXXXX (3) Install the element (8) in the pressure filter housing (6).

Note: Make sure the top of the element does not stay

#2 ENGINE OIL PRESSURE FILTER

A/C NUMBER:

CHECK BEING PERFORMED: Cust

W/C NUMBER: 242R7901 (continued)

MECH: INSP:

above the lip of the housing.

CAUTION: MAKE SURE THE FILTER (8) DOES NOT STAY OUT OF THE HOUSING (6) WHEN YOU INSTALL THE HOUSING. IF THE FILTER STAYS OUT OF THE HOUSING, YOU CAN CAUSE DAMAGE TO THE FILTER AND THE OIL SYSTEM.

_____ XXXXX (4) Install the filter housing (6) to the oil pump.

_____ XXXXX (5) Install the filter housing (6) with the bolt (5) and the washers (1 and 2).

_____ XXXXX (6) Fill the engine oil system (AMM 12-13-01/301).

D. Put the Airplane Back to Its Usual Condition.

_____ XXXXX (1) Close the right fan cowl panel (AMM 71-11-04/201).

_____ XXXXX (2) Do the test of the pressure oil filter element that is shown in the power plant test reference table (AMM 71-00-00/501).

*****END OF WORKCARD*****

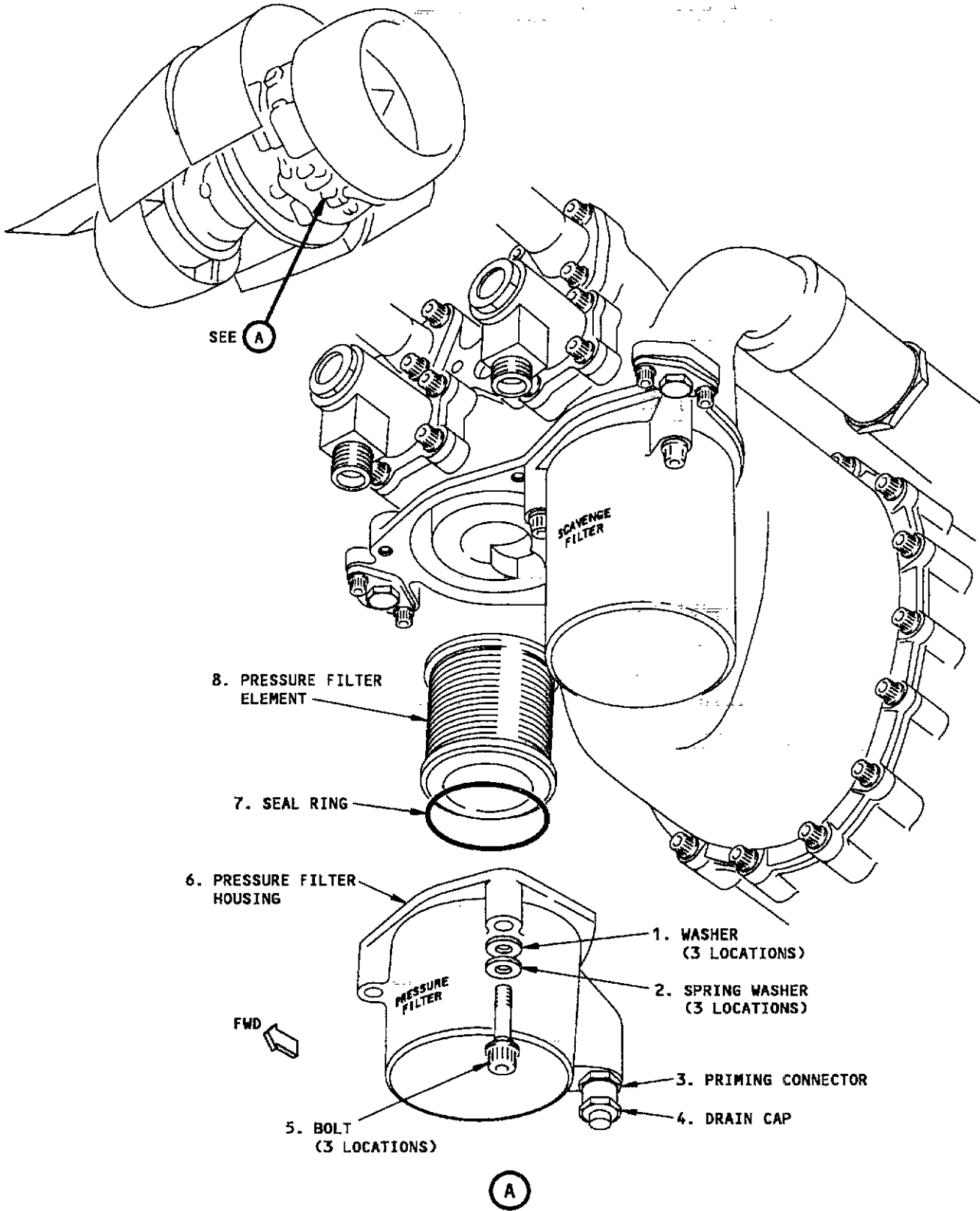

Pressure Oil Filter Element - Installation