

ATA AIRLINES, INC.

CONTROL COLUMN SWITCHING MODULE

PAGE 1 / 13

CHECK BEING PERFORMED: Custom

ZONES: 100 200
A/C NUMBER:
REV. DATE: 11/21/06
FREQUENCY: 1C

W/C NUMBER: 314F2704 DATE:

TOOLS	DESCRIPTION	QTY
A27021-29	Protractor - Control Column or Equivalent	1
C27007-31	Test Box - Cutout Switch, Stab Trim Control	1

PANELS

112A

REFERENCES

FIGURE 1

MECH INSP

MPD ITEM: 27-114-00

OPERATIONALLY CHECK THE STABILIZER TRIM CONTROL COLUMN SWITCHING MODULE.

1. Column Cutout Switches Test (Fig. 1)

A. Procedure

(1) Do the test of the captain's column cutout switch:

- | | | |
|-------|-------|---|
| _____ | XXXXX | (a) Install the protractor, A27021-29 or Equivalent on the captain's control column |
| _____ | XXXXX | (b) Disconnect the electrical connector D12156 from the captain's column cutout switch. |
| _____ | XXXXX | (c) Install the testbox, C27007-31:

1) Connect the testbox, C27007-31 connector to the captain's column cutout switch.

2) Connect the input jack on the testbox, C27007-31 to 28V DC power.

3) Set the stabilizer to 4 units of trim (B dimension equals to 39.89 inches or 1013.2 millimeters). |
| _____ | XXXXX | (d) Set the POWER and MAIN CLUTCH CUTOUT switches on the testbox, C27007-31 to the ON position.

1) Move the captain's control column to the neutral position, which is 6.9 +/- 0.8 |

REVISION DATE: 11/21/06

ATA AIRLINES, INC. B737-800 FLEET

W/C #: 314F2704

DATE WORK CARD COMPLETE ___/___/___

A/C NUMBER:

CHECK BEING PERFORMED: Cust

W/C NUMBER: 314F2704 (continued)

MECH: INSP:

degrees forward of the vertical position.

- 2) Make sure the lights on the agree with the table below:

NOTE: Ignore the lights on the AUTOPILOT STABILIZER TRIM side of the test box (right side).

LIGHT	STATUS
POWER	ON
MAIN MOTOR	OFF
MAIN CLUTCH	ON
MAIN MOTOR CUTOUT	OFF
MAIN CLUTCH CUTOUT	ON

- 3) Move the captain's control column more than 6 degrees aft of the neutral position.

- 4) Make sure the lights on the testbox, C27007-31 agree with the table below:

NOTE: Ignore the lights on the AUTOPILOT STABILIZER TRIM side of the test box (right side).

LIGHT	STATUS
POWER	ON
MAIN MOTOR	OFF
MAIN CLUTCH	OFF
MAIN MOTOR CUTOUT	OFF

A/C NUMBER:

CHECK BEING PERFORMED: Cust

W/C NUMBER: 314F2704 (continued)

MECH: INSP:

MAIN CLUTCH CUTOUT	ON
--------------------	----

5) Move the captain's control column to the neutral position,

6) Make sure the lights on the testbox, C27007-31 agree with the table below:

NOTE: Ignore the lights on the AUTOPILOT STABILIZER TRIM side of the test box (right side).

LIGHT	STATUS
POWER	ON
MAIN MOTOR	OFF
MAIN CLUTCH	ON
MAIN MOTOR CUTOUT	OFF
MAIN CLUTCH CUTOUT	ON

7) Move the captain's control column more than 4 degrees forward of the neutral position.

8) Make sure the lights on the testbox, C27007-31 agree with the table below:

NOTE: Ignore the lights on the AUTOPILOT STABILIZER TRIM side of the test box (right side).

LIGHT	STATUS
-------	--------

A/C NUMBER:

CHECK BEING PERFORMED: Cust

W/C NUMBER: 314F2704 (continued)

MECH: INSP:

POWER	ON
MAIN MOTOR	OFF
MAIN CLUTCH	OFF
MAIN MOTOR CUTOUT	OFF
MAIN CLUTCH CUTOUT	ON

_____ XXXXX (e) Set the POWER and MAIN CLUTCH CUTOUT switches on the testbox, C27007-31 to the OFF position.

_____ XXXXX (f) Set the POWER and MAIN MOTOR CUTOUT switches on the testbox, C27007-31 to the ON position.

1) Move the captain's control column to the neutral position.

2) Make sure the lights on the testbox, C27007-31 agree with the table below:

NOTE: Ignore the lights on the AUTOPILOT STABILIZER TRIM side of the test box (right side).

LIGHT	STATUS
POWER	ON
MAIN MOTOR	ON
MAIN CLUTCH	OFF
MAIN MOTOR CUTOUT	ON
MAIN CLUTCH CUTOUT	OFF

A/C NUMBER:

CHECK BEING PERFORMED: Cust

W/C NUMBER: 314F2704 (continued)

MECH: INSP:

3) Move the captain's control column more than 6 degrees aft of the neutral position.

4) Make sure the lights on the testbox, C27007-31 agree with the table below:

NOTE: Ignore the lights on the AUTOPILOT STABILIZER TRIM side of the test box (right side).

LIGHT	STATUS
POWER	ON
MAIN MOTOR	OFF
MAIN CLUTCH	OFF
MAIN MOTOR CUTOUT	ON
MAIN CLUTCH CUTOUT	OFF

5) Move the captain's control column to the neutral position,

6) Make sure the lights on the testbox, C27007-31 agree with the table below:

NOTE: Ignore the lights on the AUTOPILOT STABILIZER TRIM side of the test box (right side).

LIGHT	STATUS
POWER	ON
MAIN MOTOR	ON
MAIN CLUTCH	OFF

A/C NUMBER:

CHECK BEING PERFORMED: Cust

W/C NUMBER: 314F2704 (continued)

MECH: INSP:

MAIN MOTOR CUTOUT	ON
MAIN CLUTCH CUTOUT	OFF

7) Move the captain's control column more than 4 degrees forward of the neutral position.

8) Make sure the lights on the testbox, C27007-31 agree with the table below:

NOTE: Ignore the lights on the AUTOPILOT STABILIZER TRIM side of the test box (right side).

LIGHT	STATUS
POWER	ON
MAIN MOTOR	OFF
MAIN CLUTCH	OFF
MAIN MOTOR CUTOUT	ON
MAIN CLUTCH CUTOUT	OFF

9) Set the control column to the neutral position.

_____ XXXXX (g) Set the POWER and MAIN MOTOR CUTOUT switches on the testbox, C27007-31 to the OFF position.

_____ XXXXX (h) Disconnect the test box connectors from the captain's cutout switch connectors.

|_____ _____ (i) (RII) Connect the electrical connector D12156 to the captain's cutout switch.

A/C NUMBER:

CHECK BEING PERFORMED: Cust

W/C NUMBER: 314F2704 (continued)

MECH: INSP:

- _____ XXXXX (j) Remove the testbox, C27007-31 from the captain's control column.
- _____ XXXXX (k) Remove the protractor, A27021-29 or Equivalent from the captains control column.

(2) Do the test of the first officer's column cutout switch:

- _____ XXXXX (a) Install the protractor, A27021-29 or Equivalent on the first officer's control column.
- _____ XXXXX (b) Install the testbox, C27007-31 on the first officer's control column.
- _____ XXXXX (c) Disconnect the electrical connectors D3124 and D2257 from the first officer's column cutout switch.
- _____ XXXXX (d) Install the testbox, C27007-31:
 - 1) Connect the testbox, C27007-31 to the first officer's column cutout switch.
 - 2) Connect the input jack on the testbox, C27007-31 to 28V DC power.
- _____ XXXXX (e) Set the POWER, MAIN CLUTCH CUTOUT, AUTOPILOT MOTOR CUTOUT switches on the testbox, C27007-31 to the ON position.
 - 1) Move the first officer's control column to the neutral position, which is 6.9 +/- 0.8 degrees forward of the vertical position.
 - 2) Make sure the lights on the testbox, C27007-31 agree with the table below:

LIGHT	STATUS
POWER	ON

CONTROL COLUMN SWITCHING MODULE

A/C NUMBER:

CHECK BEING PERFORMED: Cust

W/C NUMBER: 314F2704 (continued)

MECH: INSP:

MAIN MOTOR	OFF
MAIN CLUTCH	ON
MAIN MOTOR CUTOUT	OFF
MAIN CLUTCH CUTOUT	ON
AUTOPILOT MOTOR	ON
AUTOPILOT CLUTCH	OFF
AUTOPILOT MOTOR CUTOUT	ON
AUTOPILOT CLUTCH CUTOUT	OFF

3) Move the first officer's control column more than 6 degrees aft of the neutral position.

4) Make sure the lights on the testbox, C27007-31 agree with the table below:

LIGHT	STATUS
POWER	ON
MAIN MOTOR	OFF
MAIN CLUTCH	OFF
MAIN MOTOR CUTOUT	OFF
MAIN CLUTCH CUTOUT	ON
AUTOPILOT MOTOR	OFF
AUTOPILOT CLUTCH	OFF
AUTOPILOT MOTOR CUTOUT	ON

CONTROL COLUMN SWITCHING MODULE

A/C NUMBER:

CHECK BEING PERFORMED: Cust

W/C NUMBER: 314F2704 (continued)

MECH: INSP:

AUTOPILOT CLUTCH CUTOUT	OFF
-------------------------	-----

5) Move the first officer's control column to the neutral position,

6) Make sure the lights on the testbox, C27007-31 agree with the table below:

LIGHT	STATUS
POWER	ON
MAIN MOTOR	OFF
MAIN CLUTCH	ON
MAIN MOTOR CUTOUT	OFF
MAIN CLUTCH CUTOUT	ON
AUTOPILOT MOTOR	ON
AUTOPILOT CLUTCH	OFF
AUTOPILOT MOTOR CUTOUT	ON
AUTOPILOT CLUTCH CUTOUT	OFF

7) Move the first officer's control column more than 4 degrees forward of the neutral position.

8) Make sure the lights on the testbox, C27007-31 agree with the table below:

LIGHT	STATUS
POWER	ON
MAIN MOTOR	OFF

CONTROL COLUMN SWITCHING MODULE

A/C NUMBER:

CHECK BEING PERFORMED: Cust

W/C NUMBER: 314F2704 (continued)

MECH: INSP:

MAIN CLUTCH	OFF
MAIN MOTOR CUTOUT	OFF
MAIN CLUTCH CUTOUT	ON
AUTOPILOT MOTOR	OFF
AUTOPILOT CLUTCH	OFF
AUTOPILOT MOTOR CUTOUT	ON
AUTOPILOT CLUTCH CUTOUT	OFF

_____ XXXXX (f) Set the POWER, MAIN CLUTCH CUTOUT, and AUTOPILOT MOTOR CUTOUT switches on the testbox, C27007-31 to the OFF position.

_____ XXXXX (g) Set the POWER, MAIN MOTOR CUTOUT, and AUTOPILOT CLUTCH CUTOUT switches on the testbox, C27007-31 to the ON position.

1) Move the first officer's control column to the neutral position.

2) Make sure the lights on the testbox, C27007-31 agree with the table below:

LIGHT	STATUS
POWER	ON
MAIN MOTOR	ON
MAIN CLUTCH	OFF
MAIN MOTOR CUTOUT	ON
MAIN CLUTCH CUTOUT	OFF
AUTOPILOT MOTOR	OFF

A/C NUMBER:

CHECK BEING PERFORMED: Cust

W/C NUMBER: 314F2704 (continued)

MECH: INSP:

AUTOPILOT CLUTCH	ON
AUTOPILOT MOTOR CUTOUT	OFF
AUTOPILOT CLUTCH CUTOUT	ON

3) Move the first officer's control column more than 6 degrees aft of the neutral position.

4) Make sure the lights on the testbox, C27007-31 agree with the table below:

LIGHT	STATUS
POWER	ON
MAIN MOTOR	OFF
MAIN CLUTCH	OFF
MAIN MOTOR CUTOUT	ON
MAIN CLUTCH CUTOUT	OFF
AUTOPILOT MOTOR	OFF
AUTOPILOT CLUTCH	OFF
AUTOPILOT MOTOR CUTOUT	OFF
AUTOPILOT CLUTCH CUTOUT	ON

5) Move the first officer's control column to the neutral position,

6) Make sure the lights on the testbox, C27007-31 agree with the table below:

CONTROL COLUMN SWITCHING MODULE

A/C NUMBER:

CHECK BEING PERFORMED: Cust

W/C NUMBER: 314F2704 (continued)

MECH: INSP:

LIGHT	STATUS
POWER	ON
MAIN MOTOR	ON
MAIN CLUTCH	OFF
MAIN MOTOR CUTOUT	ON
MAIN CLUTCH CUTOUT	OFF
AUTOPILOT MOTOR	OFF
AUTOPILOT CLUTCH	ON
AUTOPILOT MOTOR CUTOUT	OFF
AUTOPILOT CLUTCH CUTOUT	ON

7) Move the first officer's control column more than 4 degrees forward of the neutral position.

8) Make sure the lights on the testbox, C27007-31 agree with the table below:

LIGHT	STATUS
POWER	ON
MAIN MOTOR	OFF
MAIN CLUTCH	OFF
MAIN MOTOR CUTOUT	ON
MAIN CLUTCH CUTOUT	OFF
AUTOPILOT MOTOR	OFF
AUTOPILOT CLUTCH	OFF

CONTROL COLUMN SWITCHING MODULE

A/C NUMBER:

CHECK BEING PERFORMED: Cust

W/C NUMBER: 314F2704 (continued)

MECH: INSP:

AUTOPILOT MOTOR CUTOUT	OFF
AUTOPILOT CLUTCH CUTOUT	ON

9) Set the control column to the neutral position.

_____ XXXXX

(h) Set the POWER, MAIN MOTOR CUTOUT, and AUTOPILOT CLUTCH CUTOUT switches on the testbox, C27007-31 to the OFF position.

_____ XXXXX

(i) Disconnect the test box connectors from the first officer's cutout switch.

|_____ _____

(j) (RII) Connect the electrical connectors D3124 and D2257 to the first officer's cutout switch.

_____ XXXXX

(k) Remove the testbox, C27007-31 from the first officer's control column.

_____ XXXXX

(l) Remove the Protractor, A27021-29 or Equivalent from the first officer's control column.

*****END OF WORKCARD*****

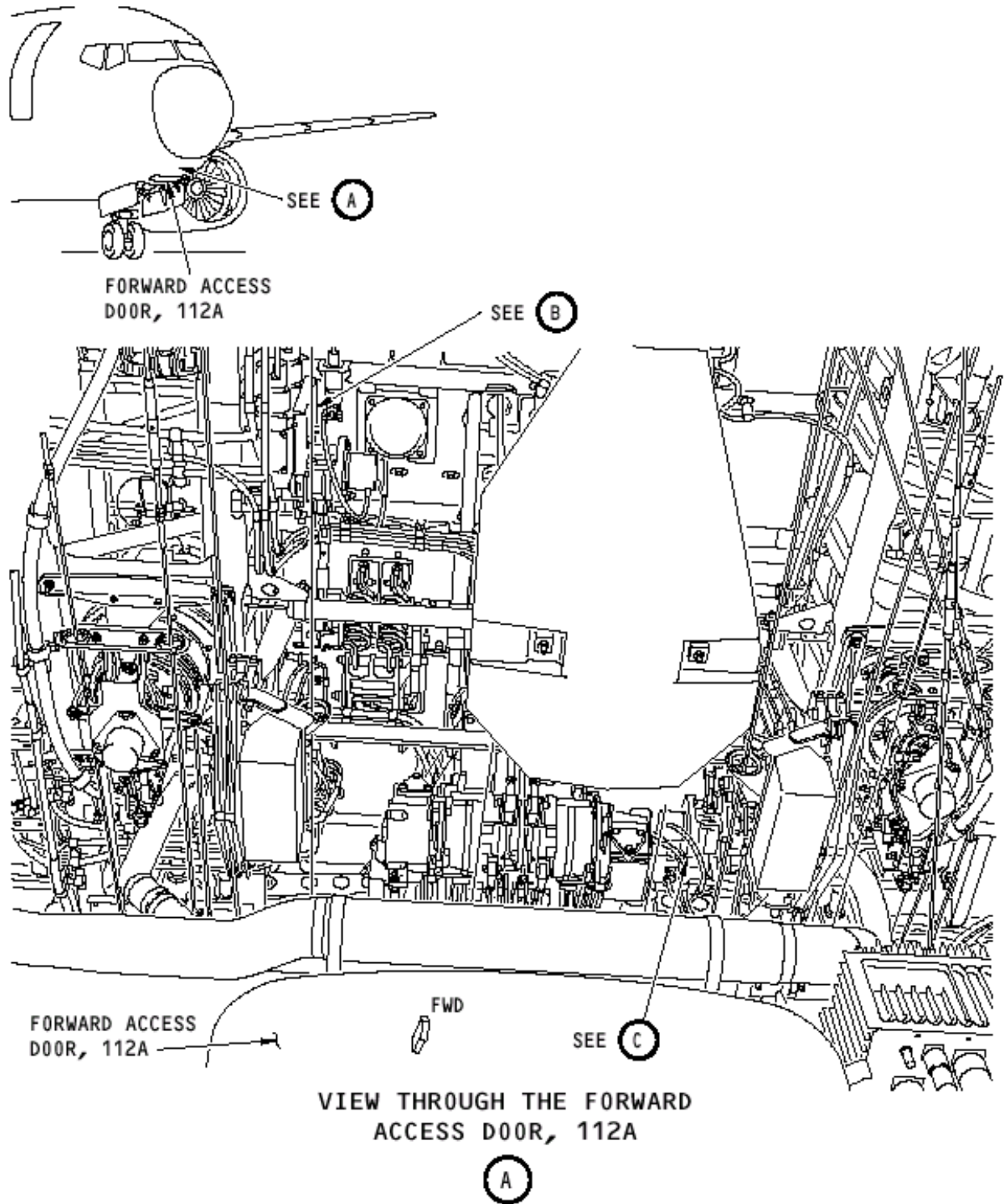

Column Cutout Switch Test

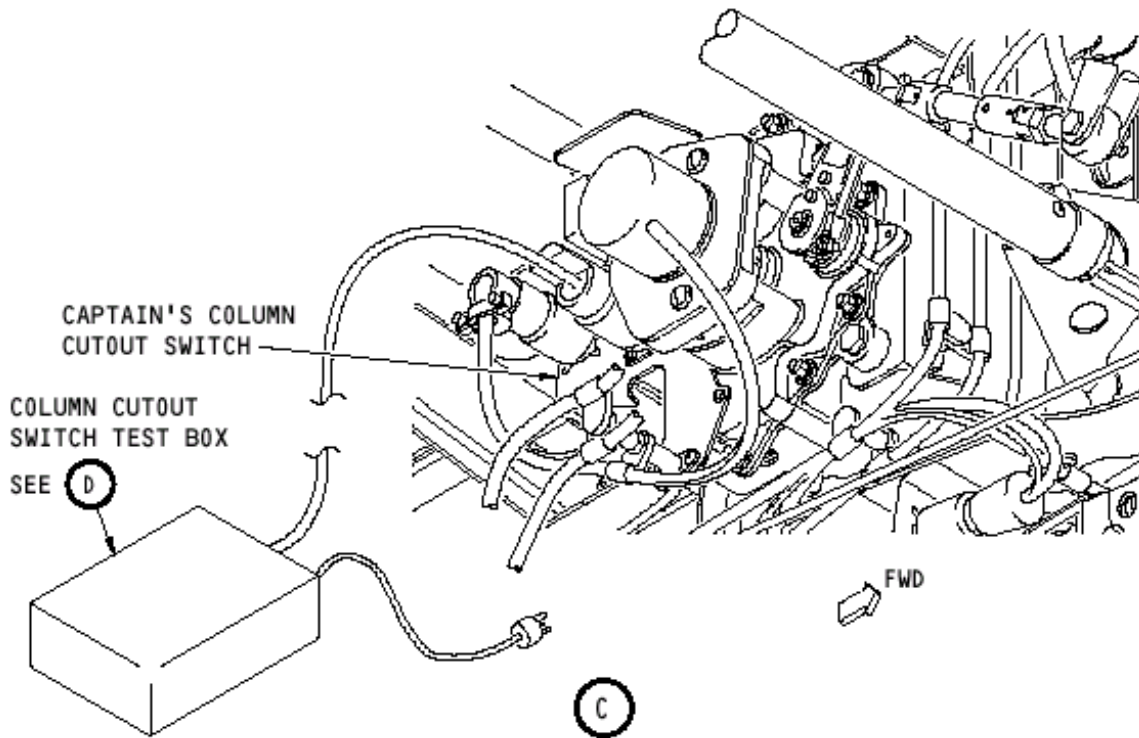
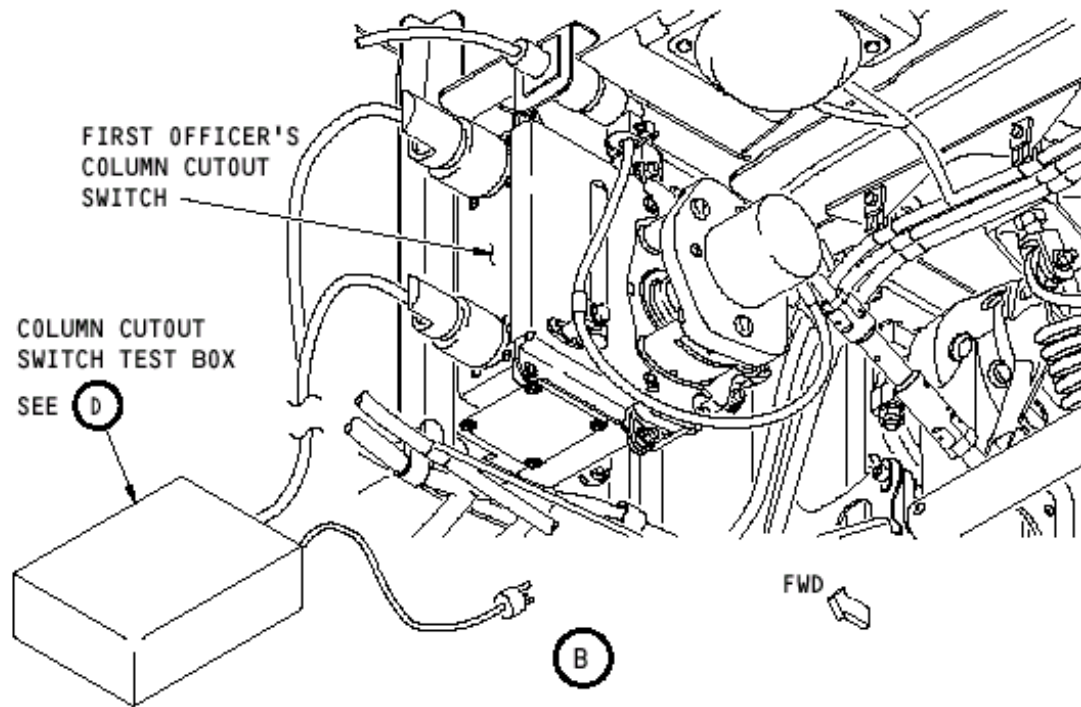

Column Cutout Switch Test

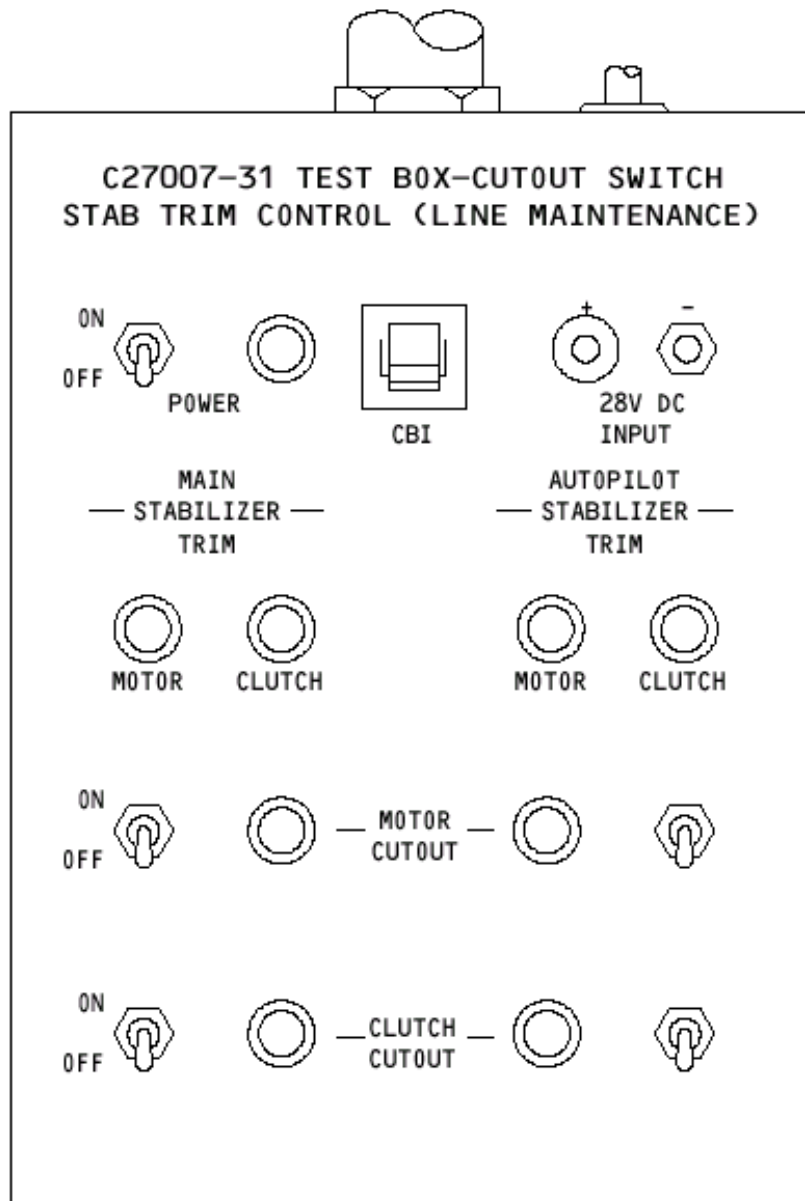

COLUMN CUTOUT SWITCH TEST BOX



Column Cutout Switch Test