

**ATA AIRLINES, INC.**

**A & B SYSTEM RETURN FILTER MODULE**

**PAGE 1 / 1**

**CHECK BEING PERFORMED: Custom**

**ZONES: 100**  
**A/C NUMBER:**  
**REV. DATE: 01/29/03**  
**FREQUENCY: 1A**

**W/C NUMBER: 317I2901**      **DATE:**

**REFERENCES**

FIGURES 1 AND 2, AMM 29-11-61

**MECH**      **INSP**

---

CHECK THE A AND B SYSTEM RETURN FILTER MODULES FOR DIFFERENTIAL PRESSURE INDICATION.

1. Inspection of the Differential Pressure Indicator of the A and B System Return Filter Modules (Figures 1 and 2).

A. Procedure

- \_\_\_\_\_    XXXXX      (1) Do a general visual inspection of the differential pressure indicator on the A system return filter module.
  - (a) Make sure the differential pressure indicator is not visable, if it is do this task:  
Hydraulic Systems A and B Return Filter Return Filter Element Removal  
(AMM TASK 29-11-61-000-801 p401)  
Return Filter Element Installation  
(AMM TASK 29-11-61-400-801 p401)
  
- \_\_\_\_\_    XXXXX      (2) Do a general visual inspection of the differential pressure indicator on the B system return filter module.
  - (a) Make sure the differential pressure indicator is not visable, if it is do this task:  
Hydraulic Systems A and B Return Filter Return Filter Element Removal  
(AMM TASK 29-11-61-000-801 p401)  
Return Filter Element Installation  
(AMM TASK 29-11-61-400-801 p401)

\*\*\*\*\*END OF WORKCARD\*\*\*\*\*

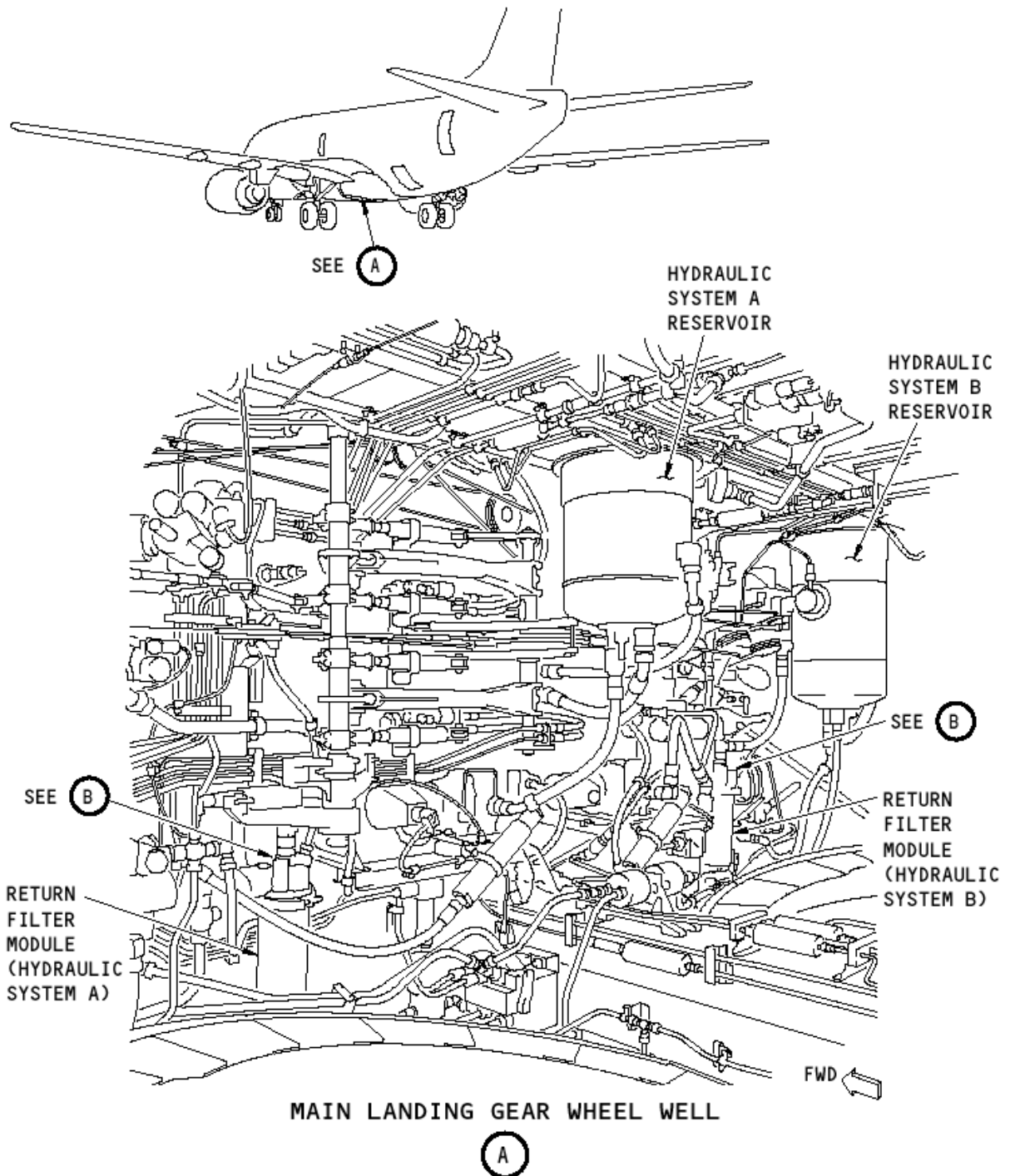

A and B Hydraulic System  
Return Filter Modules

FIGURE 1

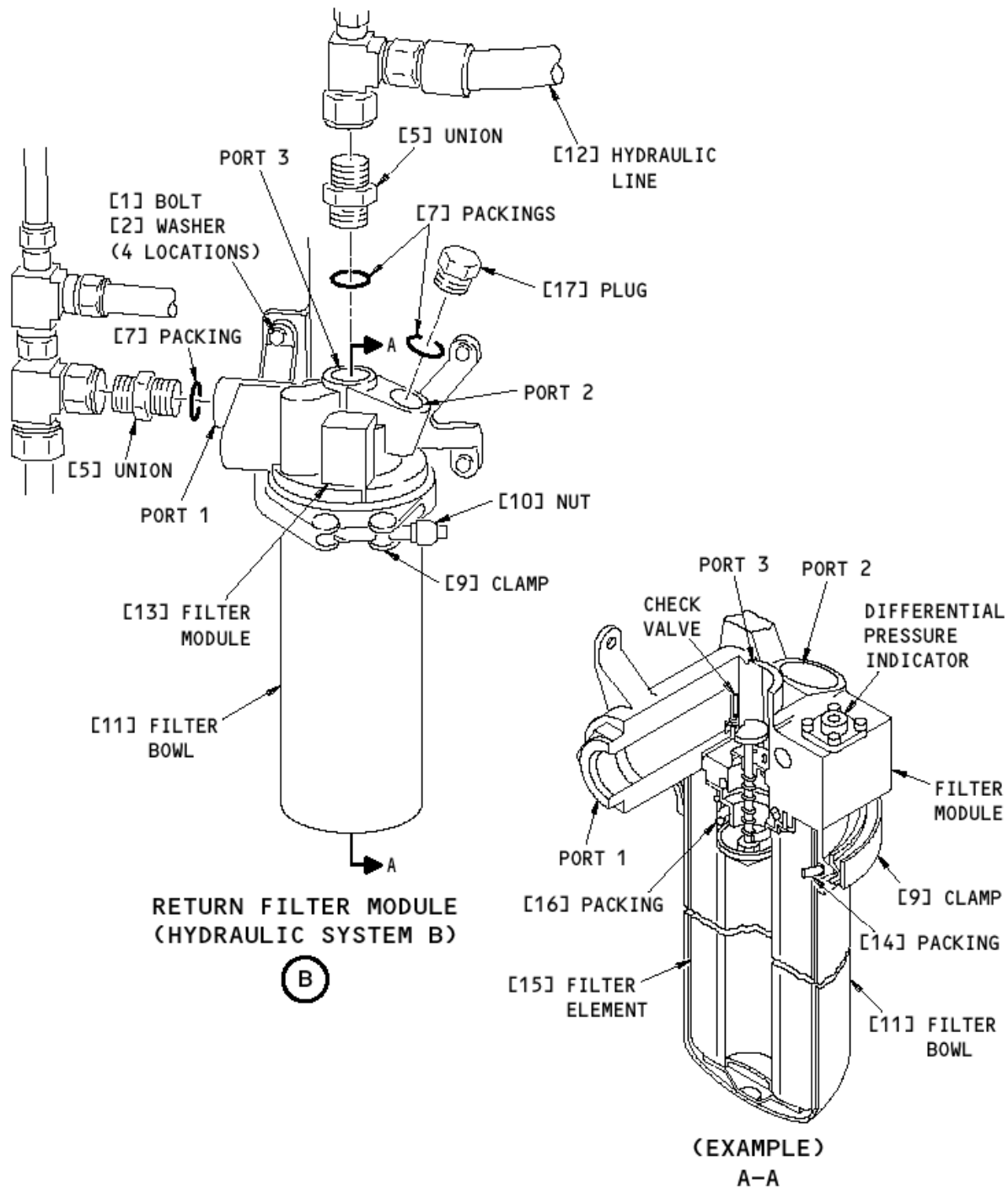

A and B Hydraulic System Return Filter Modules FIGURE 2