

ZONES: 112 117 118 211 W/C NUMBER: 321I2701 DATE:  
 A/C NUMBER:  
 REV. DATE: 11/15/07  
 FREQUENCY: 4C

## PANELS

211A  
 211B

## REFERENCES

Figure 1; AMM 24-22-00, 27-51-00, 29-11-00

MECH INSP

---

Additional Zone: 212

MPD ITEM: 27-166-00

PERFORM A DETAIL VISUAL INSPECTION OF THE TRAILING  
 EDGE FLAP LEVER SENSOR, LINKAGE, ROD AND ROD ENDS.

1. Flap Control Lever Position Sensor and Mechanism Visual  
 Inspection (Fig. 1)

XXXXX A. Prepare for the Inspection

- (1) Do this task: Supply Electrical Power, AMM Task  
 24-22-00-860-811.

WARNING: KEEP ALL PERSONS AND EQUIPMENT CLEAR OF THE FLIGHT  
 CONTROL SURFACES, THE THRUST REVERSERS, AND THE  
 LANDING GEAR. THESE COMPONENTS CAN MOVE SUDDENLY  
 WHEN YOU SUPPLY HYDRAULIC POWER. THIS CAN CAUSE  
 INJURIES TO PERSONS AND DAMAGE TO EQUIPMENT.

- (2) Supply system B hydraulic power, do this task:  
 Hydraulic System A or B Pressurization, AMM Task  
 29-11-00-860-801.

WARNING: MOVE ALL PERSONS AND EQUIPMENT AWAY FROM THE  
 TRAILING EDGE FLAPS, AND THE LEADING EDGE FLAPS  
 AND SLATS. THESE SURFACES WILL MOVE AND CAN CAUSE  
 INJURIES TO PERSONS OR DAMAGE TO EQUIPMENT.

- (3) Move the flap control lever to the 40-unit detent  
 position.
- (4) Remove system B hydraulic power, do this task:  
 Hydraulic System A or B Power Removal, AMM Task  
 29-11-00-860-805.
- (5) Remove the stabilizer trim wheel [41] from the right  
 side of the control stand [7]:

- 
- (a) Remove the bolt [42] that attaches the stabilizer trim wheel [41].
  - (b) Remove the stabilizer trim wheel [42] from the shaft.
  - (6) Remove the upper side cover [1] and lower side cover [3] from the right side of the control stand [7]:
    - (a) Remove the screws [5] and the pocket assembly [6] from the lower side cover [3].
    - (b) Remove the screws [8] that attach the upper side cover [1] and the lower side cover [3] to the control stand [7].
    - (c) Remove the upper side cover [1] and the lower side cover [3] from the control stand [7].

XXXXX \_\_\_\_\_ B. Flap Control Lever Position Sensor Visual Inspection

- (1) Do a detailed visual inspection of the flap control lever sensor assembly [2] and the crank [18].
- (2) Do a detailed visual inspection of the ends of the link [17].

C. Put the Airplane Back to Its Usual Condition

\_\_\_\_\_ XXXXX (1) Install the upper side cover [1] and the lower side cover [3] on the right side of the control stand [7]:

- (a) Put the upper side cover [1] and the lower side cover [3] in their position on the control stand [7].

NOTE: The lower side cover [3] goes under the upper side cover [1].

- (b) Install the screws [8] that attach the upper side cover [1] and lower side cover [3] to the control stand [7].
- (c) Install the pocket assembly [6] with the screws [5] on the lower side cover [3].

\_\_\_\_\_ (2) (RII) Install the stabilizer trim wheel [41] on the right side of the control stand [7]:

(a) Put the stabilizer trim wheel [41] on the shaft.

NOTE: Make sure the handle on the stabilizer trim wheel is 75 to 105 degrees from the handle on the left stabilizer trim wheel.

(b) Install the bolt [42] to attach the stabilizer trim wheel [41].

WARNING: KEEP ALL PERSONS AND EQUIPMENT CLEAR OF THE FLIGHT CONTROL SURFACES, THE THRUST REVERSERS, AND THE LANDING GEAR. THESE COMPONENTS CAN MOVE SUDDENLY WHEN YOU SUPPLY HYDRAULIC POWER. THIS CAN CAUSE INJURIES TO PERSONS AND DAMAGE TO EQUIPMENT.

\_\_\_\_\_ XXXXX (3) Supply system B hydraulic power, do this task: Hydraulic System A or B Pressurization, AMM Task 29-11-00-860-801.

WARNING: MOVE ALL PERSONS AND EQUIPMENT AWAY FROM THE TRAILING EDGE FLAPS, AND THE LEADING EDGE FLAPS AND SLATS. THESE SURFACES WILL MOVE AND CAN CAUSE INJURIES TO PERSONS OR DAMAGE TO EQUIPMENT.

\_\_\_\_\_ XXXXX (4) Move the flap control lever to the Up position to retract the flaps and slats.

\_\_\_\_\_ XXXXX (5) Remove system B hydraulic power, do this task: Hydraulic System A or B Power Removal, AMM Task 29-11-00-860-805.

\_\_\_\_\_ XXXXX (6) If electrical power is no longer required, Do this task: Remove Electrical Power, AMM Task 24-22-00-860-812.

\*\*\*\*\*END OF WORKCARD\*\*\*\*\*

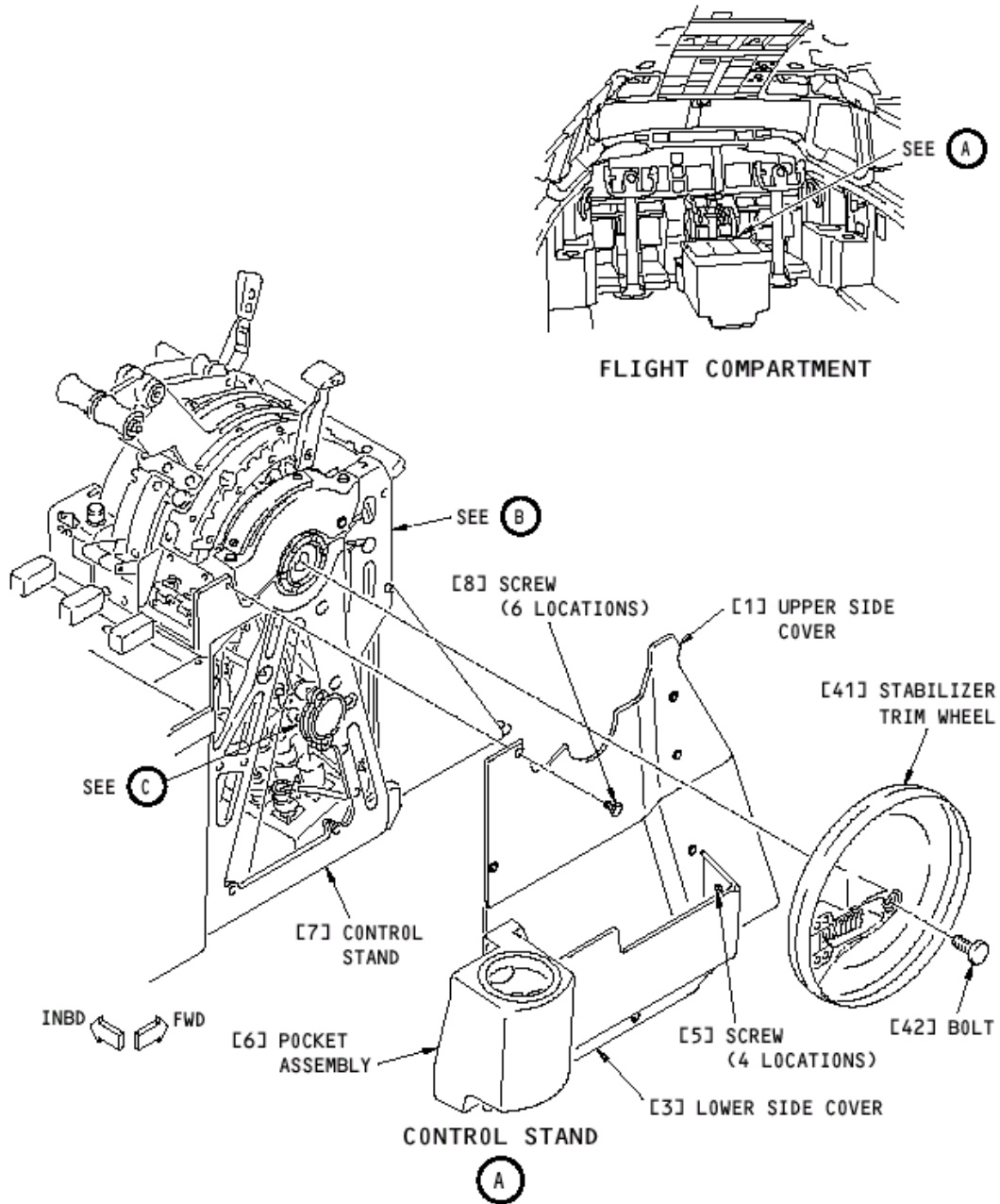

Flap Control Lever Position Sensor Inspection

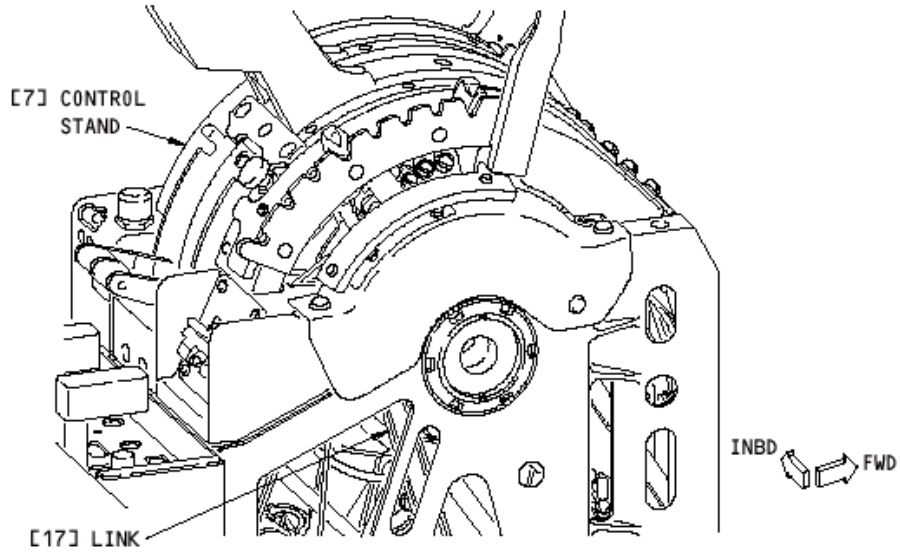

(B)

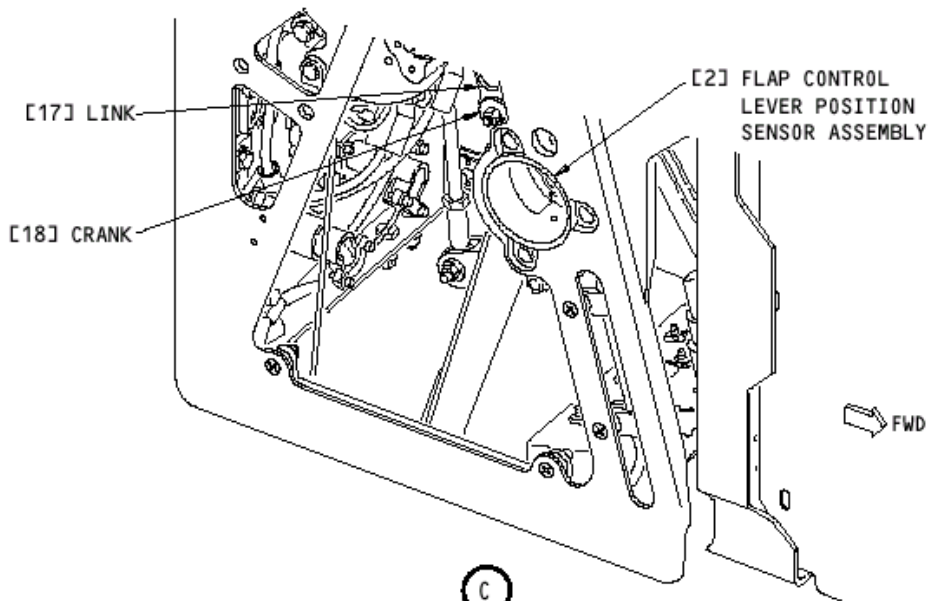

(C)

Flap Control Lever Position Sensor Inspection