

# ATA AIRLINES, INC.

OIL SUPPLY FILTER POP-OUT INDICATOR-RIGHT ENGINE

PAGE 1 / 2

CHECK BEING PERFORMED: Custom

ZONES: 400  
A/C NUMBER:  
REV. DATE: 01/30/03  
FREQUENCY: 2A

W/C NUMBER: 342I7901      DATE:

## PANELS

423BL

## REFERENCES

FIGURE 1, AMM 12-13-11, 79-00-00, 79-21-03, FIM 79 MAINT MSG INDEX

MECH      INSP

---

DETAILED INSPECTION OF THE RIGHT ENGINE OIL SUPPLY FILTER  
POP-OUT INDICATOR.

1. Oil Supply Filter Pop-Out Indicator Inspection - Visual  
Check (Figure 1)

\_\_\_\_\_ XXXXX      A. Pop-Out Indicator Visual Check

- (1) Open the applicable access door on the left fan  
cowl panel.

- (a) Chip Detector/Pressure Relief Door, Engine 2,  
423BL

- (2) Do a visual check of the pop-out indicator.

- (a) If you see that the pop-out indicator is not  
extended, no additional work is necessary.

- 1) Close the applicable access door on the  
left fan cowl panel.

- a) Chip Detector/Pressure Relief Door,  
Engine 2, 423BL

- (b) If you see that the pop-out indicator is  
extended, continue.

- (3) Do these steps if you can see the pop-out indicator:

- (a) If the OIL FILTER BYP warning light was  
illuminated on the last flight, do the  
applicable fault isolation procedure in the  
reference (FIM 79 MAINT MSG INDEX).

- (b) If the OIL FILTER BYP warning light was not  
illuminated on the last flight, then do these  
steps:

---

REVISION DATE: 01/30/03

ATA AIRLINES, INC. B737-800 FLEET

W/C #: 342I7901

DATE WORK CARD COMPLETE \_\_\_/\_\_\_/\_\_\_

A/C NUMBER:

CHECK BEING PERFORMED: Cust

W/C NUMBER: 342I7901 (continued)

MECH: INSP:

1) Do this task: Chip Detectors and Scavenge Screens Inspection (AMM TASK 79-00-00-200-804-F00 p601).

2) Replace the oil supply filter. These are the tasks: Oil Supply Filter Removal (AMM TASK 79-21-03-000-802-F00 p401), Oil Supply Filter Installation (AMM TASK 79-21-03-400-801-F00 p401).

3) Do this task: Drain the Engine Oil (AMM TASK 12-13-11-600-803 p301).

NOTE: Do this for the oil tank only.

4) Do this task: Replenish the Engine Oil (AMM TASK 12-13-11-600-801 p301).

(c) Identify the type and source of material on the oil supply filter.

1) If it has contamination, then do these steps:

a) Send the oil filter to the laboratory for analysis of the contamination.

b) Correct the cause of the contamination.

c) Do this task: Flush The Engine Oil System (AMM TASK 12-13-11-100-801 p301).

B. Put the Airplane Back to Its Usual Condition

(1) Close the applicable access door on the left fan cowl panel.

(a) Chip Detector/Pressure Relief Door, Engine 2, 423BL

\*\*\*\*\*END OF WORKCARD\*\*\*\*\*

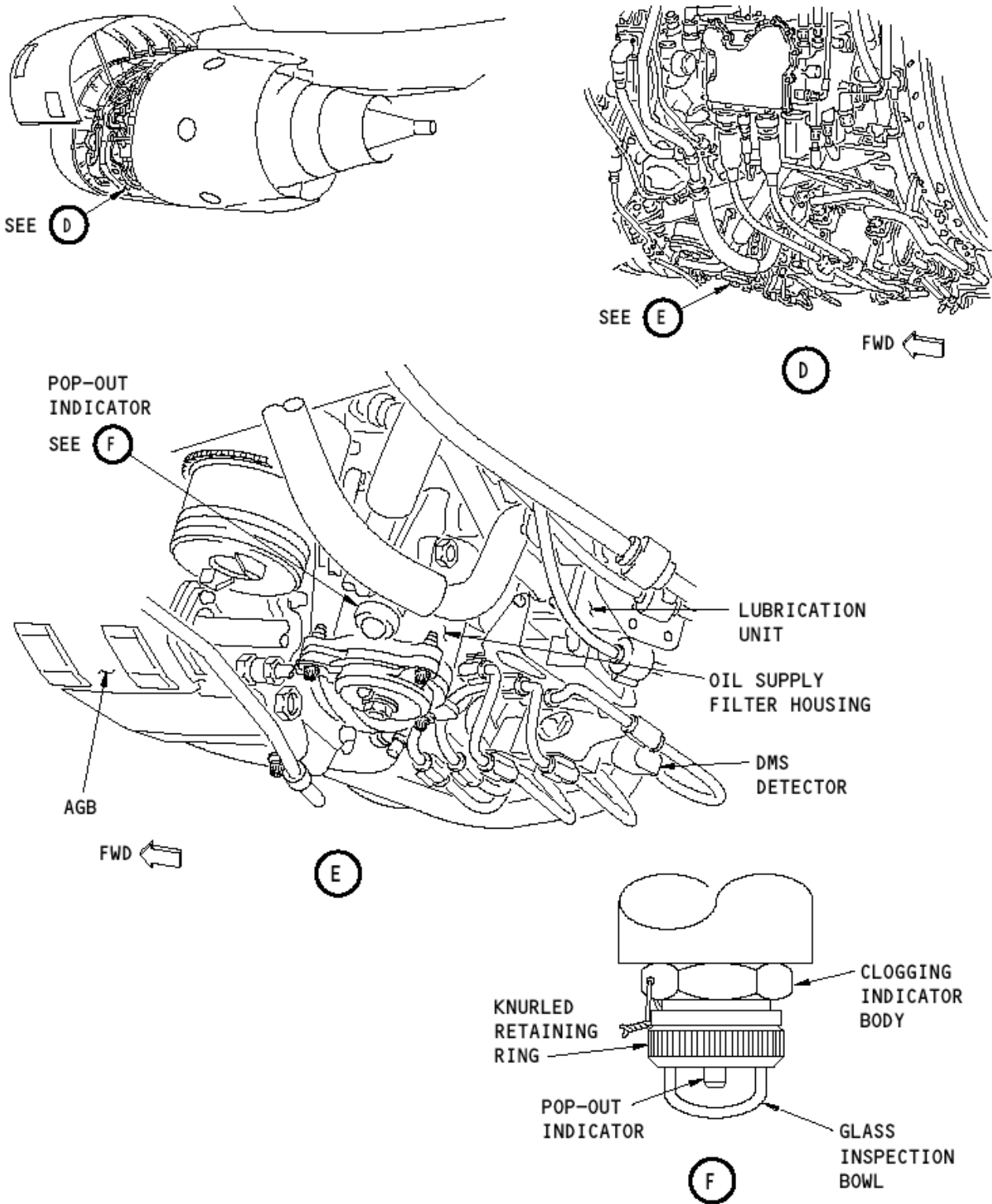

Engine Oil Filter  
Pop-Out Indicator

FIGURE 1